

SCOTTSDALE AIRPARK

**FOR LEASE ±2,933 RSF**

**THIRD FLOOR CLASS "A" OFFICE SPEC SUITE**

7345 E ACOMA DRIVE • SUITE 307 • SCOTTSDALE AZ 85260

**\$27/SF/YR FULL SERVICE**  
INCLUDES  
ELECTRIC & JANITORIAL



For additional information or to schedule a tour please contact Randy or Amanda



**Randy Shell**  
Designated Broker  
C 480.694.4100  
randy@shellcommercial.com



**Amanda Wright**  
Senior Associate  
C 480.236.0037  
amanda@shellcommercial.com

 **SHELL**  
*Commercial Investment Real Estate*  
480.443.3992 • shellcommercial.com  
16410 N 91st St | Ste 112 | Scottsdale, AZ 85260

All information contained herein is subject to prior sales and leasing. This information has been secured from sources we believe to be reliable, but we make no representation or warranties, expressed or implied, as to the accuracy of this information.

# ±2,933 RSF THIRD FLOOR CLASS “A” OFFICE SUITE

## BUILDING FEATURES:

- Three Story Class “A” Office / Hangar building adjacent to airport taxiway
- Beautiful contemporary lobby area with waiting areas and seating for guests
- Common Conference room in lobby area for tenant’s use
- High-end tenant mix with tenant directory on first floor
- Secure Access Control throughout building
- Common restrooms on each floor
- Three story office portion of building has open atrium-like setting w/ great natural light and seating area on ground floor
- Elevator
- Great views from the offices
- Convenient impressive drive-up front entrance with parking for guests
- Covered parking available
- Amazing location near high-end restaurants and amenities such as Kierland, Scottsdale Quarter, The Promenade Scottsdale and future new major development, The Parque
- Direct northbound/southbound access from Scottsdale Road with signal light at Scottsdale Road and Acoma Drive
- I-1 Zoning, City of Scottsdale



# FLOOR PLAN

7345 E ACOMA DRIVE • SUITE 307 • SCOTTSDALE AZ 85260

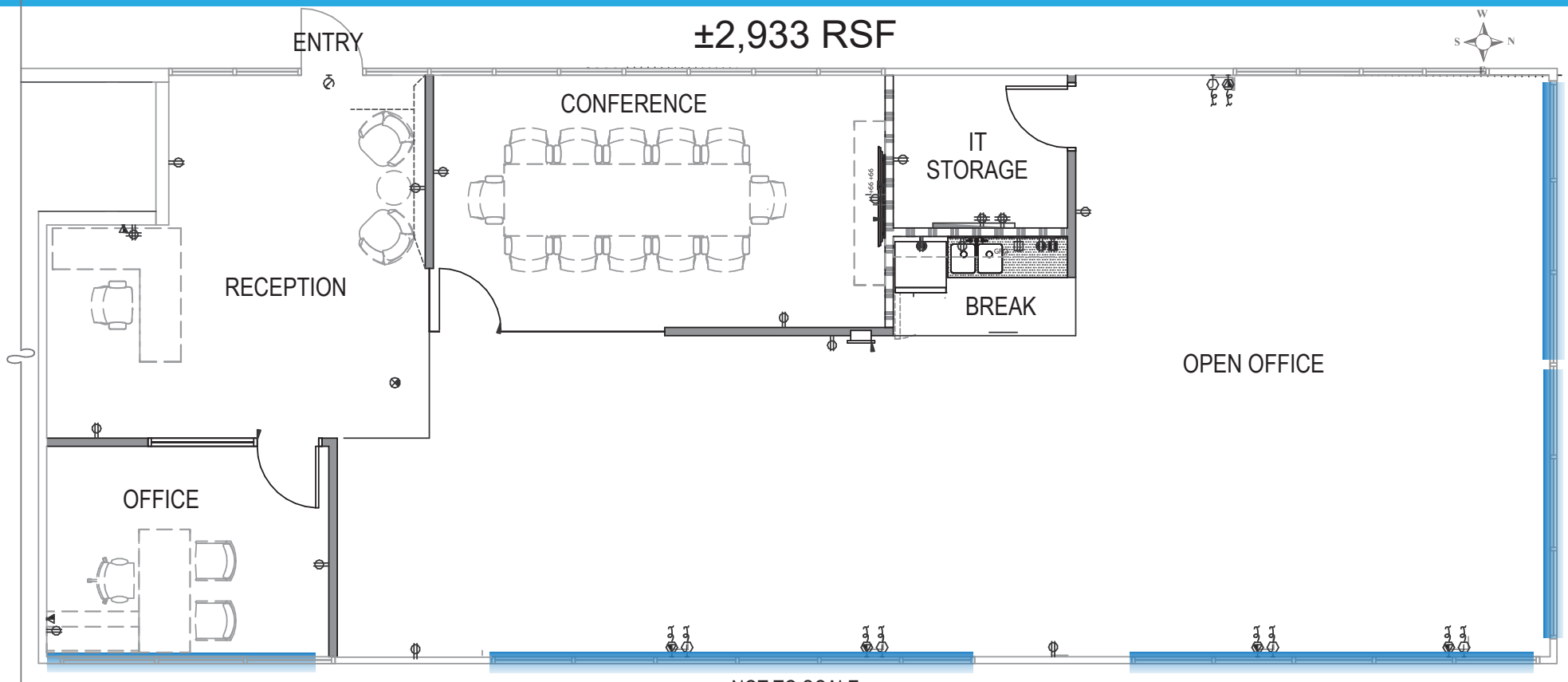

NOT TO SCALE

All information furnished regarding property for sale, rental or financing is from sources deemed reliable, but no warranty or representation is made to the accuracy thereof and same is submitted to errors, omissions, change of price, rental or other conditions, prior to sale, lease or financing or withdrawal without notice. No liability of any kind is to be imposed on the broker herein. This information has been secured from sources deemed reliable, however, we make no warranties as to its accuracy.





7345 E ACOMA DRIVE • SUITE 307 • SCOTTSDALE AZ 85260



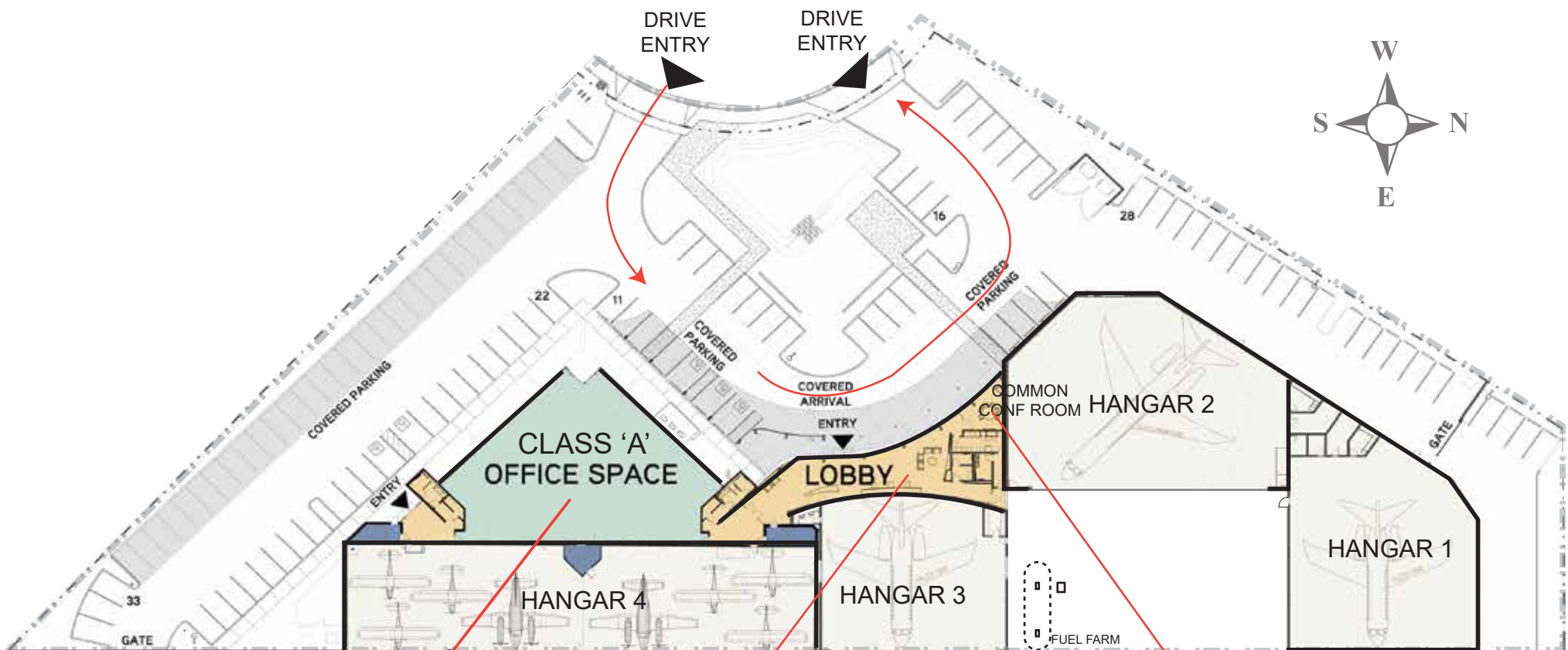

← RUNWAY ACCESS →

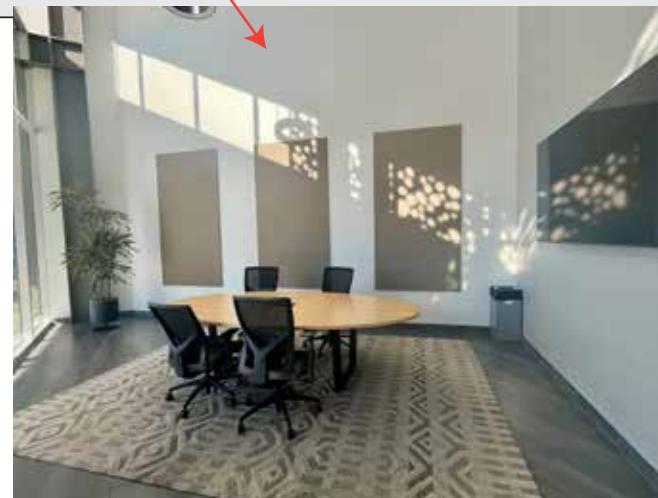

7345 E ACOMA DRIVE • SUITE 307 • SCOTTSDALE AZ 85260

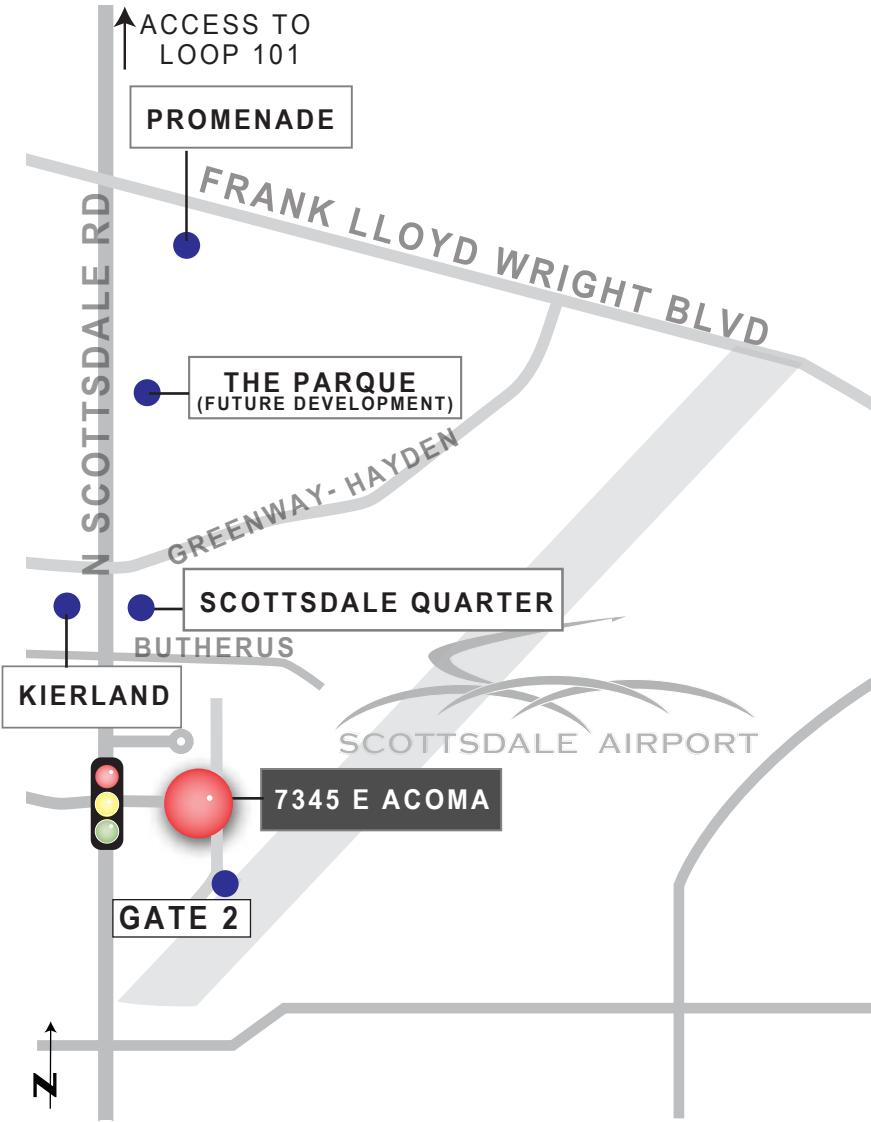

KIERLAND COMMONS



SCOTTSDALE AIRPORT



SCOTTSDALE QUARTER